

REVISIONS		
NO.	DESCRIPTION	DATE

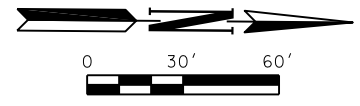

LEGEND	
	1 1/2" ELECT. CONDUIT (EXPOSED)
	2" ELECT. PVC CONDUIT (TRENCHED)
	2" ELECT. CONDUIT (BORED)
	EXISTING CONDUIT
	SPECIAL MEDIAN BARRIER PULL BOX
	SIZE 1 PULL BOX
	ELECTRIC SERVICE LOCATION
	CIRCUIT DESIGNATION
	LIGHT POLE W/O BREAKAWAY BASE
	LIGHT POLE W/ BREAKAWAY BASE
	TWIN LIGHT POLE W/O BREAKAWAY BASE
	TWIN LIGHT POLE W/ BREAKAWAY BASE

*R. Wayne Russell*  
 R. WAYNE RUSSELL, P.E. # 16030  
 C.A. # 1160, RENEWAL 06-30-17

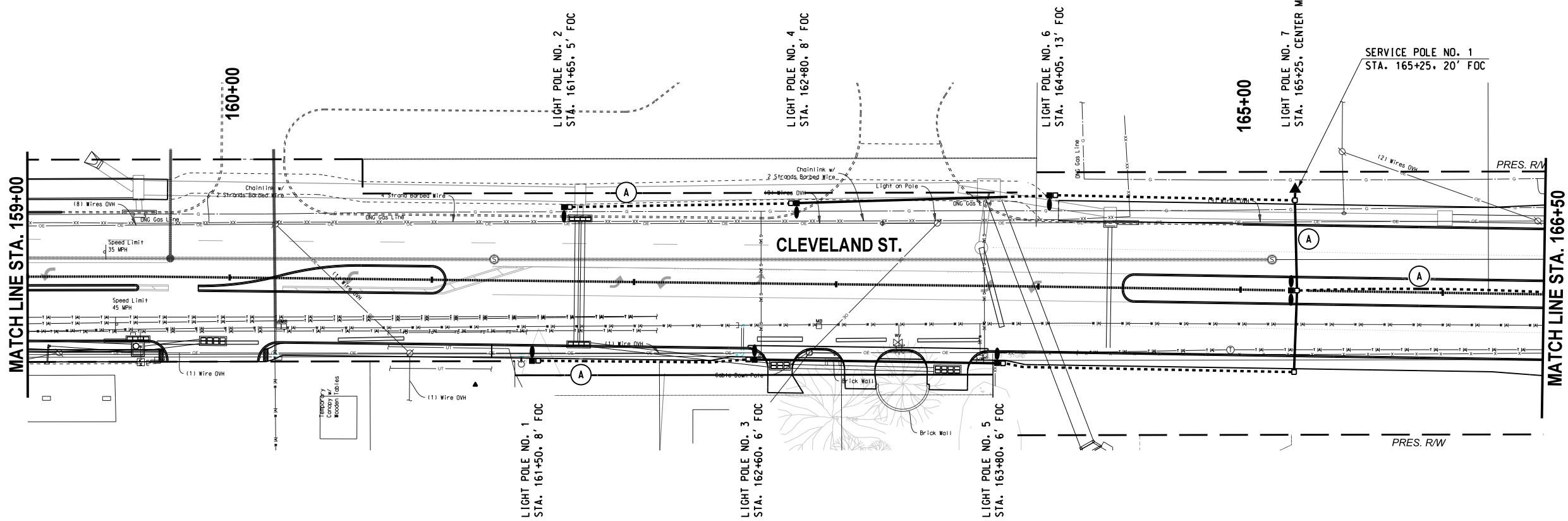
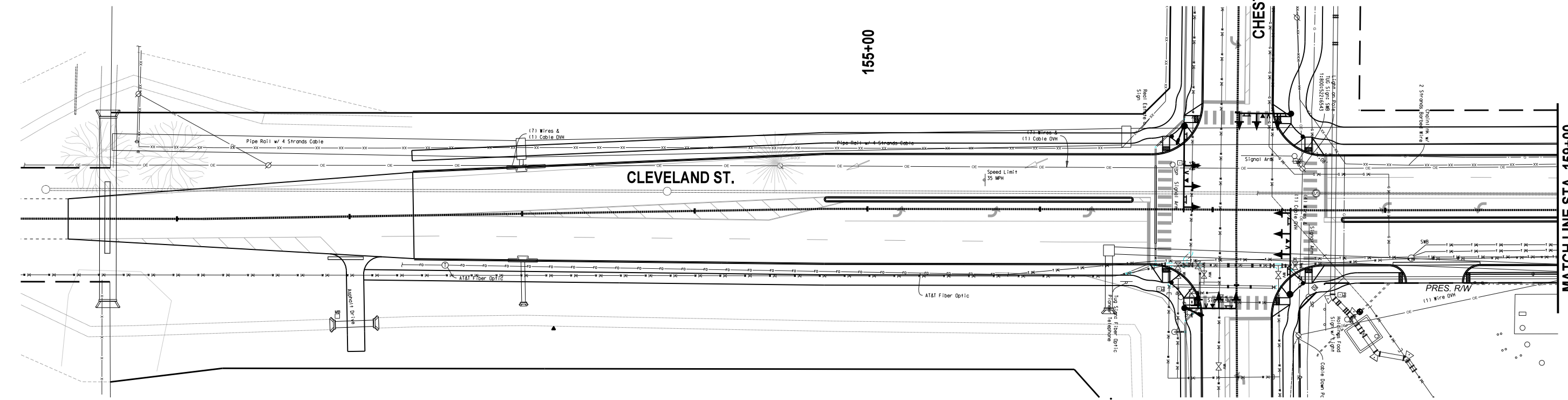
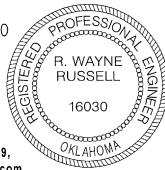

12-12-16  
 DATE

Traffic Engineering Consultants, Inc.  
 6000 S. Western, Suite 300 - Oklahoma City, OK 73139,  
 Ph: 405-720-7721, Fax: 405-720-9848, Web: www.tecok.com

Design	RWR	2/14/2016
Drawn	SB	2/14/2016



**LIGHTING PLAN**  
**CLEVELAND ST.**  
**(1 OF 2)**

Project No. R-1311B Sheet No. T3

12/14/2016 G:\0\Projects\T-2280 Cleveland St & Chestnut Ave - Engr, OK\CAD\R-311B BLVD\LIGHT Ldgn